



AppleHouse
Seasonal hours vary,
mid-August through
mid-December
The AppleHouse is 1.5 miles
west of the Arboretum
off Hwy. 5 and Rolling Acres
Road. It features apples,
pumpkins, squash
and seasonal décor.

**AVAILABLE AT THE
OSWALD VISITOR CENTER**

Restrooms

Dining

First Aid

Information

Shopping

Tram Stop
and Tickets

**SPEED
LIMIT
15**

**AVAILABLE AT THE
SNYDER BUILDING**

Restrooms

Andersen
Horticultural
Library

Meyer-Deats
Conservatory

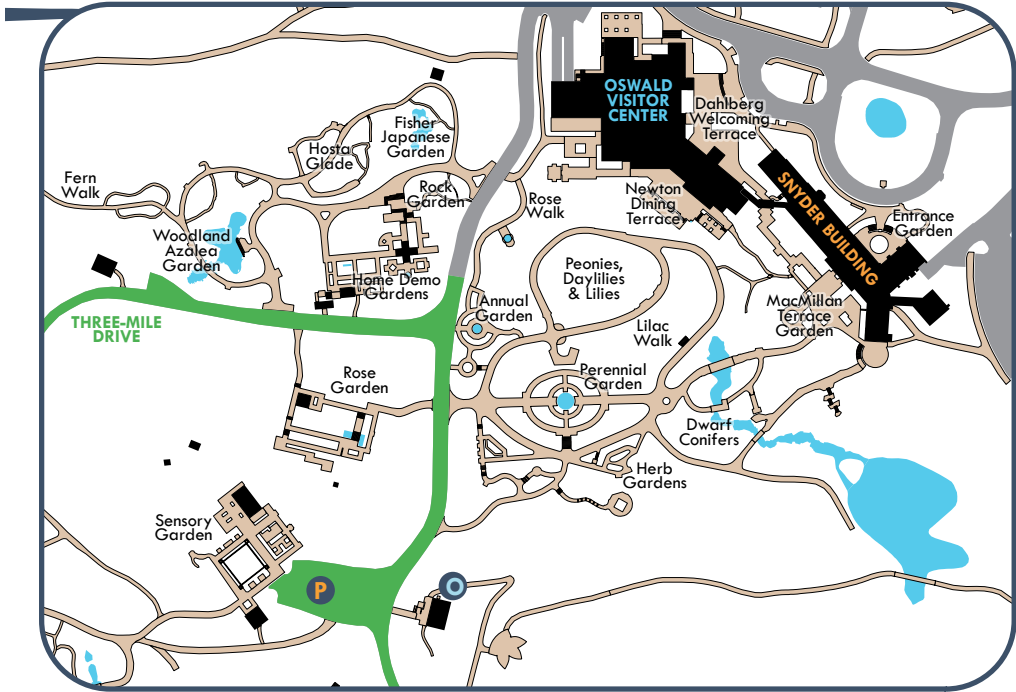

KEY

Bee-Line
Shuttle Stop
(When operating)

Restrooms

Parking

Margot
Picnic Area

Ordway Picnic
Shelter &
Trex Deck

Picnic
Tables

Regional Trail

Roads

Three-Mile Drive

Three-Mile Walk

Paved Walkway

Unpaved Walkway

Boardwalk

Pond/Stream

Wetlands

