

2016 SCHOOLYARD GARDENS CONFERENCE
AN ECOSYSTEM OF LEARNING: SHARING COMMON GROUND

Members of the planning team extend their sincere and heartfelt thanks to the sponsors, donors, patrons and endorsing organizations noted below for their generous support of this conference and its mission.

SPONSOR

Minnesota Department of Education
 University of Minnesota Extension
 Master Gardener Volunteer Program

ENDORISING ORGANIZATIONS

Bloomington Public Health
 Columbia Heights Public Schools
 Edina Public Schools
 EnergyScapes, Inc.
 Gardening Matters
 Ground Works- Midwest
 Growing West Side
 Harvest Moon Edible Landscapes
 Hopkins Department of Nutrition & Lifestyle Services
 Houston County Public Health
 Jeffers Foundation
 Life Time Foundation
 Midwest Food Connection
 Minneapolis Public Schools Culinary and Nutrition Services

Minnesota Action for Healthy Kids
 Minnesota Agriculture in the Classroom
 The Minnesota Association for Environmental Education (MAEE)
 Minnesota Department of Agriculture
 Minnesota Department of Health
 Minnesota Green Schools Coalition
 Minnesota Grown
 Minnesota Institute for Sustainable Agriculture (MISA)
 Minnesota Science Teachers Association (MnSTA)
 Public Health Law Center
 SLP Seeds
 University of Minnesota Extension Center for Family Development
 University of Minnesota Monarch Lab
 USGBC-MN
 Youth Farm







2016 Schoolyard Gardens Conference

An Ecosystem of Learning, Sharing Common Ground

Friday, March 4, 8:30 a.m. – 4:00 p.m.



2016 SCHOOLYARD GARDEN CONFERENCE AGENDA
AN ECOSYSTEM OF LEARNING: SHARING COMMON GROUND
MacMillan Auditorium
MARCH 4, 2016 8:30 A.M. TO 4:00 P.M.
Minnesota Landscape Arboretum

8:00	Registration Open (Great Hall), coffee/tea (Reedy Gallery)			
8:30	Welcome and Housekeeping (MACMILLAN AUDITORIUM) CARRIE STOWERS- Minnesota Landscape Arboretum JANICE BAD MOCCASIN - Dakota Prayer Leader— Shakopee Mdewakanton Sioux Community TERRI SWARTOUT- Minnesota Department of Education and Minnesota Department of Health on behalf of the MNSGC JEFFERS FOUNDATION VIDEO- "Minnesota Schoolyard Gardens" ROSE MCGEE- EMCEE, Creator, Sweet Potato Comfort Pie Initiative		 Audience participation session using Pigeonhole Live- go to pigeonhole.at and enter SYG2016	
9:10	Keynote Presentation BETTI WIGGINS - Executive Director, Detroit Public Schools' Office of Nutrition			
10:00	Break/Networking			
10:10	Town Hall Interactive Forum BETTI WIGGINS - Executive Director, Detroit Public Schools' Office of Nutrition			
11:00	Lunch: Please note the lunch assignments on your chair. Menu: Locally Sourced Roasted Root Vegetable Gratin with Gruyere, Caesar Salad, Rustic Artisan Baguette, Rose McGee's Sweet Potato Pie			
CONCURRENT SESSIONS IN OSWALD VISITOR CENTER				
	MACMILLAN AUD. A/C	MACMILLAN AUD. B/D	AZALEA CLASSROOM	TEACHING CLASSROOM
	RESOURCES FOR SUSTAINABILITY	SCHOOLYARD GARDEN 101	FARM TO SCHOOL	CURRICULUM CONNECTIONS
12:00-12:50	Principals' Round Table KATHI KUSCH MARSHALL, RAY APONTE, BRIAN INGEMANN, GINA MEINERTZ 	STEM in the Garden SUE KNOTT	Garden to Cafeteria Pilot Program ANDREA NORTHUP	Food, Farming & Fun: Wolf Ridge Organic Farm Finland, MN DAVID ABAZS
1:00-1:50	The Buzz on Pollinators and Beekeeping VICTORIA RANUA, SARAH WEAVER, and RANDY GAGE 	Minnesota Schoolyard Garden Coalition Networking & Informational Session MNSGC STEWARDSHIP TEAM	Think Small: Demystifying Early Learning in the Garden EMILY SPARLING	Winter Gardening in Minnesota Classrooms with a Tower Garden DIANE BEZDICEK
2:00-2:50	School Gardens and Educational Curriculum UNITE A Teacher's Roundtable STEPHANIE HEIM	Square Foot and Vertical Growing: Methods for Engaging Youth in Gardening JOAN JAMES	Farm to Childcare Panel: The Freshest for the Youngest ERIN MCKEE VAN SLOOTEN, RAMONA ROBINSON, MOLLY TURNQUIST	Linking the Lunchroom and the Classroom HARUKO RUGGIERO, EMILY HOUSER
3:00-3:50	Overview of Legal and Policy Issues with Using Schoolyard Garden Produce MARY MARROW	Growing for Equity in the Suburbs GREG HERDER	Extracting Value from School Gardens JASON REESE	Garden & Farm-based Programming with School-Age Children ANGELICA ADAMS

2016 SCHOOLYARD GARDEN CONFERENCE AGENDA
AN ECOSYSTEM OF LEARNING: SHARING COMMON GROUND
MacMillan Auditorium
MARCH 4, 2016 8:30 A.M. TO 4:00 P.M.
Minnesota Landscape Arboretum

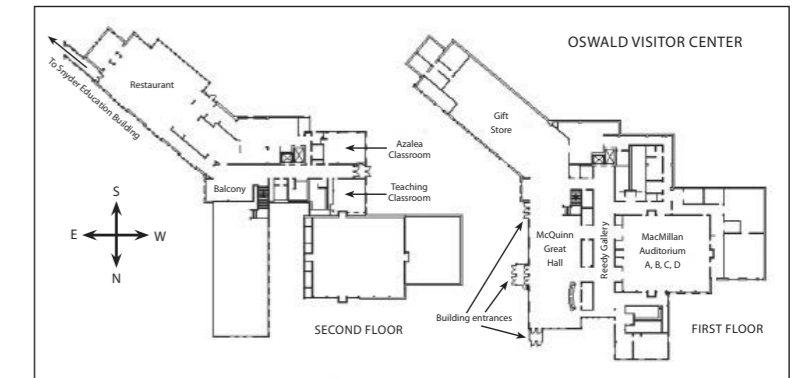
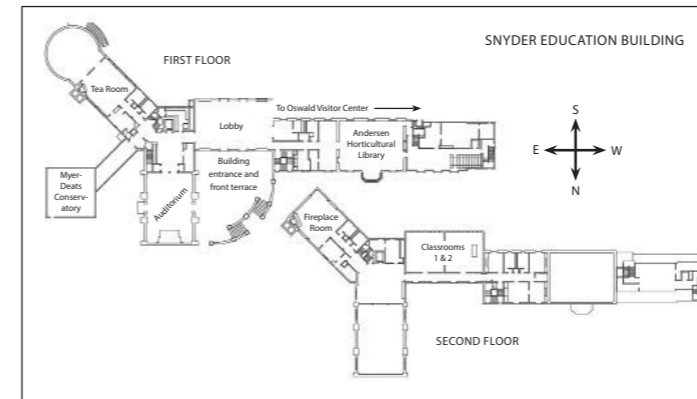

CONCURRENT SESSIONS IN SNYDER BUILDING			
	SNYDER AUDITORIUM	CLASSROOM 2	EXHIBITOR SHOWCASE SNYDER LOBBY
	<i>HORTICULTURE BEST PRACTICES</i>	<i>SCHOOLYARD GARDENS 101: HANDS-ON LEARNING SESSION</i>	Bluff Creek Elementary
12:00-12:50	Growing Small Fruit in the Garden and Attracting the Right Pollinators KARL FOORD	YES! Youth Eating Smart, Summer & After School Programming GROUND WORKS – MIDWEST SESSION I	Jeffers Foundation Minnesota Agriculture in the Classroom The Monarch Lab-University of Minnesota
1:00-1:50	Genetic Engineering of Food: The Challenge of Communicating a Complex and Controversial Subject In the Classroom NEVIN YOUNG	YES! Youth Eating Smart, Summer & After School Programming GROUND WORKS – MIDWEST SESSION II	Minnesota Department of Education Minnesota Schoolyard Garden Coalition Pollinate Minnesota
2:00-2:50	Building Soil: Roots of Success LIZ PERKUS, MICHELLE DOBRATZ	Project Sweetie Pie MICHAEL CHANEY	Project Sweetie Pie Renewing the Countryside
3:00-3:50	Hydroponic Gardening: The Easy Way LARRY CIPPOLA	Pollinators & Beekeeping in the Garden VICTORIA RANUA	Shakopee Mdewakanton Sioux Community Tribal Garden Resources USGBC/MN Green Schools Coalition YES! Youth Eating Smart/Ground Works- Midwest

2016 Minnesota Schoolyard Garden Coalition Stewardship Team Members:

Bonnie Lohman Callie Recknagel
 Kirsten Saylor Lori Murphy

For more information about the MNSGC or for schoolyard garden resources, email mnscoalition@gmail.com.